

# Stainless Steel Grease Anchor Blocks

Part Numbers RGB1SS, RGB2SS, RGB3SS, RGB4SS, RGB5SS, RGB6SS, RGB8SS

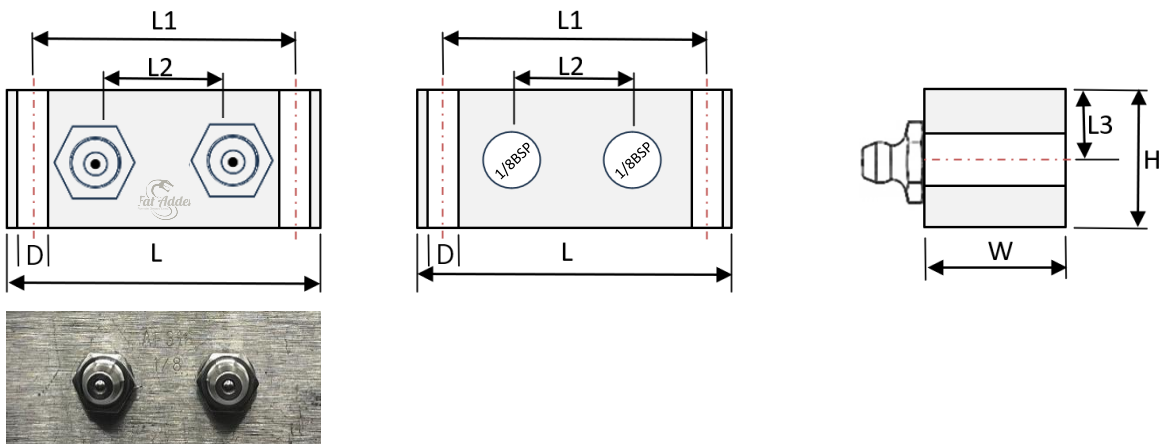

Fat Adder offers Stainless Steel Grease Anchor Blocks with stainless steel grease nipples. These are suitable for remote grease lines.



Part Number	No of Connections	Nipple Thread	Measurements in mm						
			L	L1	L2	L3	W	H	D
RGB1SS	1	1/8BSP	38	28		12.5	20	20	6.5
RGB2SS	2	1/8BSP	60	50	22	12.5	20	20	6.5
RGB3SS	3	1/8BSP	84	74	22	12.5	20	20	6.5
RGB4SS	4	1/8BSP	106	96	22	12.5	20	20	6.5
RGB5SS	5	1/8BSP	128	118	22	12.5	20	20	6.5
RGB6SS	6	1/8BSP	150	140	22	12.5	20	20	6.5
RGB8SS	8	1/8BSP	194	184	22	12.5	20	20	6.5

Grease Anchor Block Material: Stainless Steel 316

Grease Nipple Material: Stainless Steel 304

Fat Adder Remote Grease Lines  
 Manufactured and Distributed by Lube Control Pty Ltd  
 Head Office: 23 Arabrie Ave, Edwardstown, South Australia, 5039  
[www.remotegreaselines.com.au](http://www.remotegreaselines.com.au) p: 1300 917 946

e: [sales@lubecontrol.com.au](mailto:sales@lubecontrol.com.au)

product overview